



SURVEYOR'S OFFICE

Hamilton County

Kenton C. Ward, Surveyor

Phone (317) 776-8495

Fax (317) 776-9628

Suite 188

One Hamilton County Square

Noblesville, Indiana 46060-2230

October 17, 2003

To: Hamilton County Drainage Board

Re: J. W. Brendle Drain, Wexley Chase Arm

Attached is a petition filed by GWZ-Z Development LLC along with a non-enforcement request, plans, calculations, quantity summary and assessment roll for the Wesley Chase Arm, J. W. Brendle Drain to be located in Clay Township. I have reviewed the submittals and petition and have found each to be in proper form.

I have made a personal inspection of the land described in the petition. Upon doing so, I believe that the drain is practicable; will improve the public health; benefit a public highway and be of public utility; and that the costs, damages, and expenses of the proposed drain will probably be less than the benefits accruing to the owners of land likely to be benefited. The drain will consist of the following:

6" SSD	7,875 ft	15" RCP	594 ft	24" RCP	199 ft
12" RCP	1,829 ft	18" RCP	367 ft		

The total length of the drain will be 10,864 feet.

The retention ponds (lakes) located in Common Areas B and C are to be considered part of the regulated drain. Only the inlet and outlet will be maintained as part of the regulated drain. The maintenance, such as mowing, of the ponds (lakes) will be the responsibility of the Homeowners Association. The Board will however, retain jurisdiction for ensuring the storage volume for which the lake was designed will be retained. Thereby, allowing no fill or easement encroachments.

The subsurface drains (SSD) to be part of the regulated drain are those located under the curbs and those main lines between lots or in rear yards. Only the main SSD lines, which are located within the easement (right of way), are to be maintained as regulated drain. Laterals for individual lots will not be considered part of the regulated drain. The portion of the SSD which will be regulated other than those under curbs are as follows:

Within Common Area B in the dry basin.

I have reviewed the plans and believe the drain will benefit each lot equally. Therefore, I recommend each lot be assessed equally. I also believe that no damages will result to landowners by the construction of this drain. I recommend a maintenance assessment of \$10.00 per acre for common areas and platted lots, \$10.00 per acre for roadways with a \$65.00 minimum. With this assessment the total annual assessment for this drain/this section will be \$2,956.10.

The petitioner has submitted surety for the proposed drain at this time. Surety will be submitted prior to the approval of the Hamilton County Board of Commissioners/commencement of construction. The sureties which are in the form of a Letter of Credit are as follows:

Agent: Madison Community Bank
Date: July 16, 2003
Number: 3225
For: Erosion Control
Amount: \$48,075.00

Agent: Madison Community Bank
Date: July 16, 2003
Number: 3226
For: Storm Sewers
Amount: \$139,898.00

Parcels assessed for this drain may be assessed for the Long Branch Drain at sometime in the future. Parcels assessed for this drain will be assessed as the J. W. Brendle Drain.

I believe this proposed drain meets the requirements for Urban Drain Classification as set out in IC 36-9-27-67 to 69. Therefore, this drain shall be designated as an Urban Drain.

I recommend that upon approval of the above-proposed drain that the Board also approve the attached non-enforcement request. This request is for the reduction of the regulated drain easement to those easement widths as shown on the secondary plat for Wexley Chase as recorded in the office of the Hamilton County Recorder.

I recommend the Board set a hearing for this proposed drain for November 24, 2003.

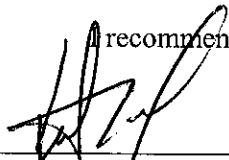

Kenton C. Ward
Hamilton County Surveyor

KCW/llm

STATE OF INDIANA)
)
COUNTY OF HAMILTON)

TO: HAMILTON COUNTY DRAINAGE BOARD
% Hamilton County Surveyor, Courthouse, Noblesville, IN 46060

In the matter of Wexley Chase Subdivision,
Section _____ Drain Petition.

Petitioner is the owner of all lots in the land affected by the proposed new regulated drain. The drainage will affect various lots in Wexley Chase, a subdivision in Hamilton County, Indiana. The general route of such drainage shall be in existing easements and along public roads as shown in the plans on file in the Surveyor's Office.

Petitioner believes that the cost, damages and expenses of the proposed improvement will be less than the benefits which will result to the owners of the land likely to be benefited thereby. Petitioner believes the proposed improvements will:

- (a) improve public health
- (b) benefit a public street
- (c) be of public utility

Petitioner agrees to pay the cost of construction of the drainage system and requests periodic maintenance assessments by the Board thereafter.

The Petitioner also agrees to the following:

1. To provide the Drainage Board a Performance Bond for the portion of the drainage system which will be made a regulated drain. The bond will be in the amount of 100% of the Engineers estimate. The bond will be in effect until construction of 100% of the system is completed and so certified by the Engineer.
2. The Petitioner shall retain an Engineer throughout the construction phase. At completion of the project the Petitioner's Engineer shall certify that the drainage system which is to be maintained as a regulated drain has been constructed as per construction plans.

3. The Petitioner agrees to request in writing to the County Surveyor any changes from the approved plan and must receive written authorization from the County Surveyor prior to implementation of the change. All changes shall be documented and given to the Surveyor to be placed in the Drain File.
4. The Petitioner shall instruct his Engineer to provide a reproducible print on a 24" X 36" mylar of the final design of the Drainage System. This shall be submitted to the County Surveyor prior to the release of the Performance Bond.
5. The Petitioner shall comply with the Erosion Control Plan as specified on the construction plans. Failure to comply with the Erosion Control Plan shall be determined by the Board as being an obstruction of the drainage system. The County Surveyor shall immediately install or repair the needed measures at Petitioners cost as per IC 36-9-27-46.

The Petitioner further requests that the Drain be classified as an Urban Drain.

GWZ-2 DEVELOPMENT, LLC

Signed

Co-Manager

Mark A. Zukerman, Co Manager

Printed Name

Signed

Printed Name

RECORDED OWNER(S) OF LAND INVOLVED

DATE: May 21, 2003

**BANNING ENGINEERING, PC
ENGINEERS ESTIMATE**

Project Name: wexley chase
Project Number: 02129

Date: 2/1/2003
Item: Erosion Control

DESCRIPTION	QUANTITY	UNIT	UNIT PRICE	TOTAL
SEEDING	35000	SYDS	\$0.55	\$19,250.00
EROSION BLANKETS	8500	SYDS	\$1.25	\$10,625.00
SILT FENCE	3000	LF	\$2.50	\$7,500.00
GABION		SYDS	\$33.00	\$0.00
RIP-RAP	300	SYDS	\$24.00	\$7,200.00

FILED

FEB 26 2003

OFFICE OF HAMILTON COUNTY SURVEYOR

GROSS TOTAL				\$44,575.00
CONTENGENCIES 10%				\$4,457.50
NET TOTAL				\$49,032.50

**BANNING ENGINEERING, PC
ENGINEERS ESTIMATE**

Project Name: wexley chase
Project Number: 02129

Date: 2/1/2003
Item: Storm

DESCRIPTION	QUANTITY	UNIT	UNIT PRICE	TOTAL	
10" CPP PIPE (SOLID)		LF		\$0.00	
12" CPP PIPE (SOLID)		LF	\$3.58	\$0.00	
15" CPP PIPE (SOLID)		LF		\$0.00	
18" CPP PIPE (SOLID)		LF		\$0.00	
24" CPP PIPE (SOLID)		LF	\$12.03	\$0.00	
30" CPP PIPE (SOLID)		LF	\$19.33	\$0.00	
36" CPP PIPE (SOLID)		LF		\$0.00	
42" CPP PIPE (SOLID)		LF		\$0.00	
48" CPP PIPE (SOLID)		LF		\$0.00	
INLET / BEEHIVE	13	EA.	\$850.00	\$11,050.00	
MANHOLES	9	EA.	\$1,600.00	\$14,400.00	
12" END SECTION (CONC.)	7	EA.	\$270.00	\$1,890.00	
15" END SECTION (CONC.)	2	EA.	\$325.00	\$650.00	
18" END SECTION (CONC.)	1	EA.	\$350.00	\$350.00	
24" END SECTION (CONC.)	1	EA.	\$400.00	\$400.00	
30" END SECTION (CONC.)		EA.	\$525.00	\$0.00	
36" END SECTION (CONC.)		EA.	\$700.00	\$0.00	
42" END SECTION (CONC.)		EA.	\$900.00	\$0.00	
12" END SECTION (POLY.)		EA.	\$60.00	\$0.00	
GRANULAR BACKFILL	600	CYDS	\$10.00	\$6,000.00	
6" SUB-SURFACE	5800	LF	\$4.25	\$24,650.00	
4" SUB-SURFACE LOT HOOK-UPS	400	LF	\$4.50	\$1,800.00	
GROSS TOTAL					\$110,261.00
CONTENGENCIES 10%					\$11,026.10
NET TOTAL					\$121,287.10

**BANNING ENGINEERING, PC
ENGINEERS ESTIMATE**

Project Name: wexley chase
Project Number: 02129

Date: 2/1/2003
Item: Storm

DESCRIPTION	QUANTITY	UNIT	UNIT PRICE	TOTAL
12" RCP PIPE	1591	LF	\$17.00	\$27,047.00
15" RCP PIPE	617	LF	\$18.00	\$11,106.00
18" RCP PIPE	327	LF	\$20.00	\$6,540.00
21" RCP PIPE	199	LF	\$22.00	\$4,378.00
24" RCP PIPE		LF	\$26.00	\$0.00
27" RCP PIPE		LF	\$30.00	\$0.00
30" RCP PIPE		LF	\$33.00	\$0.00
36" RCP PIPE		LF	\$44.00	\$0.00
42" RCP PIPE		LF	\$52.00	\$0.00
48" RCP PIPE		LF	\$62.00	\$0.00
4" HDPE PIPE (SOLID)		LF	\$0.46	\$0.00
6" HDPE PIPE (SOLID)		LF	\$1.27	\$0.00
8" HDPE PIPE (SOLID)		LF	\$2.25	\$0.00
10" HDPE PIPE (SOLID)		LF	\$2.96	\$0.00
12" HDPE PIPE (SOLID)		LF	\$3.44	\$0.00
15" HDPE PIPE (SOLID)		LF	\$5.75	\$0.00
18" HDPE PIPE (SOLID)		LF	\$8.23	\$0.00
24" HDPE PIPE (SOLID)		LF	\$9.35	\$0.00
30" HDPE PIPE (SOLID)		LF	\$14.12	\$0.00
36" HDPE PIPE (SOLID)		LF	\$21.35	\$0.00
42" HDPE PIPE (SOLID)		LF	\$40.75	\$0.00
48" HDPE PIPE (SOLID)		LF	\$48.00	\$0.00
4" HDPE PIPE (PERF)		LF	\$0.46	\$0.00
6" HDPE PIPE (PERF)		LF	\$1.27	\$0.00
8" HDPE PIPE (PERF)		LF	\$2.25	\$0.00
10" HDPE PIPE (PERF)		LF	\$3.21	\$0.00
12" HDPE PIPE (PERF)		LF	\$4.70	\$0.00
15" HDPE PIPE (PERF)		LF	\$5.95	\$0.00
18" HDPE PIPE (PERF)		LF	\$8.23	\$0.00
24" HDPE PIPE (PERF)		LF	\$11.93	\$0.00
30" HDPE PIPE (PERF)		LF	\$18.25	\$0.00
36" HDPE PIPE (PERF)		LF	\$22.35	\$0.00
4" CPP PIPE (SOLID)		LF		\$0.00
6" CPP PIPE (SOLID)		LF		\$0.00
8" CPP PIPE (SOLID)		LF		\$0.00



July 16, 2003

Beneficiary: Hamilton County Board of Commissioners
1 Hamilton County Square
Noblesville, IN 46060

Applicant: GWZ-2 Development LLC
9011 N. Meridian Street, Suite 202
Indianapolis, IN 46260

RE: Our Irrevocable Standby Letter of Credit No. 3225
Expiration Date and Place: July 16, 2004, available by draft(s) at sight at
The counters of Madison Community Bank.

Gentlemen:

By order of our client, GWZ-2 Development, LLC, we hereby issue our Irrevocable Standby Letter of Credit #3225, in your favor, for an amount not to exceed in the aggregate Forty Eight Thousand Seventy Five and 00/100 US Dollars (USD \$48,075.00), available by draft at sight drawn on Madison Community Bank when accompanied by the following documents:

Beneficiary's purported signed certificate stating that GWZ-2 Development LLC has failed to complete the Erosion Control in Wexley Chase.

Partial drawings are permitted.

We hereby undertake with you to honor each draft drawn under and in compliance with the terms of this Letter of Credit, if duly presented together with the documents specified at this office on or before the stated expiration date.

Except as otherwise stated, this Letter of Credit is subject to the Uniform Customs and Practice for Documentary Credit (1993 Revision), International Chamber of Commerce Publication No. 500.

Very truly yours,

Kirk A. Klabunde
Vice President

33 WEST TENTH STREET
ANDERSON, IN 46016

100 WEST STATE STREET
PENDLETON, IN 46064-0210



July 16, 2003

Beneficiary: Hamilton County Board of Commissioners
1 Hamilton County Square
Noblesville, IN 46060

Applicant: GWZ-2 Development LLC
9011 N. Meridian Street, Suite 202
Indianapolis, IN 46260

RE: Our Irrevocable Standby Letter of Credit No. 3226
Expiration Date and Place: July 16, 2004, available by draft(s) at sight at
The counters of Madison Community Bank.

Gentlemen:

By order of our client, GWZ-2 Development, LLC, we hereby issue our Irrevocable Standby Letter of Credit #3226, in your favor, for an amount not to exceed in the aggregate One Hundred Thirty Nine Thousand Eight Hundred Ninety Eight and 00/100 US Dollars (USD \$139,898.00), available by draft at sight drawn on Madison Community Bank when accompanied by the following documents:

Beneficiary's purported signed certificate stating that GWZ-2 Development LLC has failed to complete the Storm Sewers in Wexley Chase.

Partial drawings are permitted.

We hereby undertake with you to honor each draft drawn under and in compliance with the terms of this Letter of Credit, if duly presented together with the documents specified at this office on or before the stated expiration date.

Except as otherwise stated, this Letter of Credit is subject to the Uniform Customs and Practice for Documentary Credit (1993 Revision), International Chamber of Commerce Publication No. 500.

Very truly yours,

Kirk A. Klabunde
Vice President

33 WEST TENTH STREET
ANDERSON, IN 46016

100 WEST STATE STREET
PENDLETON, IN 46064-0210

FINDINGS AND ORDER

CONCERNING THE MAINTENANCE OF THE

J. W. Brendle Drain, Wexley Chase Arm

On this *24th day of November 2003*, the Hamilton County Drainage Board has held a hearing on the Maintenance Report and Schedule of Assessments of the *J. W. Brendle Drain, Wexley Chase Arm*.

Evidence has been heard. Objections were presented and considered. The Board then adopted the original/amended Schedule of Assessments. The Board now finds that the annual maintenance assessment will be less than the benefits to the landowners and issues this order declaring that this Maintenance Fund be established.

HAMILTON COUNTY DRAINAGE BOARD

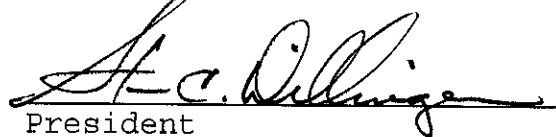
President

Member

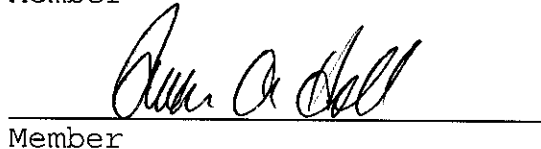
Member

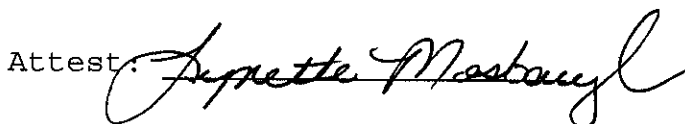
Attest: 

CERTIFICATE OF COMPLETION AND COMPLIANCE

To: Hamilton County Surveyor

Re: Wexley Chase Subdivision

I hereby certify that:

1. I am a Registered Land Surveyor or Engineer in the State of Indiana.
2. I am familiar with the plans and specifications for the above referenced subdivision.
3. I have personally observed and supervised the completion of the drainage facilities for the above referenced subdivision.
4. The drainage facilities within the above referenced subdivision to the best of my knowledge, information and belief have been installed and completed in conformity with all plans and specifications.

Signature: Brian L. Haggard Date: 02/11/04

Type or Print Name: Brian L. Haggard, Banning Engineering, P.C.

Business Address: 698 Tower Road, Suite 100

Plainfield, IN 46168

Telephone Number: (317) 839-2581

SEAL

INDIANA REGISTRATION NUMBER

29800001



Valenti-Held, Inc.

4355 S. Indianapolis Road
Whitestown, IN 46075-9537

317-769-6922 (Ext. 108)
317-769-5525 (Fax)

LETTER OF TRANSMITTAL

05/14/2003	JOB NO.
Lance Ferrell	
Banning Engineers	
698 Tower Road, Suite 100	
Indianapolis, IN 46240	
(317) 839-2581 (o)	
(317) 838-9171 (f)	

WE AREA SENDING YOU

ATTACHED SPECIFICATIONS CONTRACTS
 PRINTS SHOP DRAWINGS OTHER

COPIES	DATE	DESCRIPTION
1		Storm and SSD Unit Cost sheets for Wexley Chase

THESE ARE TRANSMITTED AS NOTED BELOW:

FOR APPROVAL AS REQUESTED
 FOR REVIEW & COMMENT RETURN COPIES
 FOR YOUR RECORDS OTHER

REMARKS Please call with any questions 714-1130.

FILED

MAY 20 2003

OFFICE OF HAMILTON COUNTY SURVEYOR

COPY TO: FILE

SIGNED: Kevin Brown
Estimator

If enclosures are not as noted, kindly notify us at once.

STORM SEWERS UNIT COSTS			
Wexley Chase			
Depth	Quantity *	Unit Cost	Total Cost
12" Pipe (LF)	1810	\$18.00	\$32,580
12" End Sect. (EA)	7	\$750.00	\$5,250
12" Trash G. (EA)		\$125.00	\$0
15" Pipe (LF)	459	\$20.00	\$9,180
15" End Sect. (EA)	2	\$800.00	\$1,600
15" Trash G. (EA)		\$167.50	\$0
18" Pipe (LF)	502	\$22.50	\$11,295
18" End Sect. (EA)	1	\$850.00	\$850
18" Trash G. (EA)		\$175.00	\$0
21" Pipe (LF)	0	\$22.50	\$0
21" End Sect. (EA)	0	\$900.00	\$0
21" Trash G. (EA)		\$200.00	\$0
24" Pipe (LF)	199	\$28.50	\$5,672
24" End Sect. (EA)	1	\$950.00	\$950
24" Trash G. (EA)		\$250.00	\$0
27" Pipe (LF)	0	\$31.00	\$0
27" End Sect. (EA)	0	\$1,050.00	\$0
27" Trash G. (EA)		\$300.00	\$0
30" Pipe (LF)	0	\$35.00	\$0
30" End Sect. (EA)	0	\$1,150.00	\$0
30" Trash G. (EA)		\$350.00	\$0
33" Pipe (LF)	0	\$39.00	\$0
33" End Sect. (EA)	0	\$1,250.00	\$0
33" Trash G. (EA)		\$350.00	\$0
36" Pipe (LF)	0	\$45.00	\$0
36" End Sect. (EA)	0	\$1,500.00	\$0
36" Trash G. (EA)		\$350.00	\$0
42" Pipe (LF)	0	\$50.00	\$0
42" End Sect. (EA)	0	\$1,800.00	\$0
42" Trash G. (EA)		\$350.00	\$0
48" Pipe (LF)	0	\$55.00	\$0
48" End Sect. (EA)	0	\$2,100.00	\$0
48" Trash G. (EA)		\$350.00	\$0
Std. Manhole (EA)	15	\$1,700.00	\$25,500
Large Manhole (EA)	2	\$2,400.00	\$4,800
Double Inlet Manhole (EA)		\$1,800.00	\$0
Inlets (EA)	8	\$1,300.00	\$10,400
Sand Backfill (TN)	806	\$6.00	\$4,836
Rip Rap (TN)	121	\$25.00	\$3,025
TOTAL			\$115,938

Valenti Held Contractor/Developer, Inc.

FILED

MAY 20 2003

OFFICE OF HAMILTON COUNTY SURVEYOR

05/14/2003

9:04 AM

Wexley Chase Final.xls

SUBSURFACE DRAINS UNIT COSTS			
Wexley Chase			
	Quantity *	Unit Cost	Total Cost
4" SSD Under Curb	LF 0	\$3.25	\$0
6" SSD Under Curb	LF 5600	\$3.85	\$21,560
Loc Laterals	EA 40	\$60.00	\$2,400
TOTAL			> \$23,960

WATER MAINS UNIT COSTS			
Wexley Chase			
Depth	Quantity *	Unit Cost	Total Cost
3" Main (LF)	0	\$11.75	\$0
3" Gate Valve(EA)		\$800.00	\$0
3" Blow-Off(EA)		\$700.00	\$0
6" Main (LF)	602	\$14.00	\$8,428
6" Gate Valve(EA)		\$850.00	\$0
6" Blow-Off(EA)		\$750.00	\$0
8" Main (LF)	2227	\$17.25	\$38,416
8" Gate Valve(EA)	9	\$1,000.00	\$9,000
8" Blow-Off(EA)		\$800.00	\$0
10" Main (LF)	0	\$19.50	\$0
10" Gate Valve(EA)		\$1,100.00	\$0
10" Blow-Off(EA)		\$1,000.00	\$0
12" Main (LF)	0	\$21.50	\$0
12" Gate Valve(EA)		\$1,500.00	\$0
12" Blow-Off(EA)		\$1,200.00	\$0
16" Main (LF)	0	\$25.50	\$0
16" Gate Valve(EA)		\$2,000.00	\$0
16" Blow-Off(EA)		\$1,500.00	\$0
Fire Hydrants (EA)	9	\$1,725.00	\$15,525
FH Aux Valves (EA)	7	\$850.00	\$5,950
Street Cut	1	\$2,800.00	\$2,800
Sand Backfill (TN)	132	\$6.50	\$858
TOTAL			> \$80,977

WATER LATERALS UNIT COSTS			
Wexley Chase			
Depth	Quantity *	Unit Cost	Total Cost
1" SERVICE LATERALS	LF 2280	\$7.00	\$15,960
LATERAL TAPS	EA 40	\$75.00	\$3,000
GRANULAR BACKFILL	TN 286	\$6.50	\$1,859
TOTAL			> \$20,819

FILED
MAY 20 2003

OFFICE OF HAMILTON COUNTY SURVEYOR

Valenti Held Contractor/Developer, Inc.

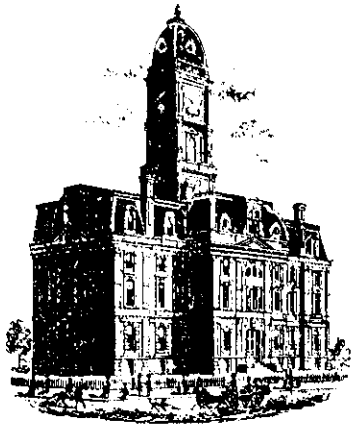

SURVEYOR'S OFFICE

Hamilton County

Kenton C. Ward, Surveyor

Phone (317) 776-8495

Fax (317) 776-9628

Suite 188

One Hamilton County Square

Noblesville, Indiana 46060-2230

To: Hamilton County Drainage Board

June 21, 2005

Re: JW Brendle Drain: Wexley Chase Arm

Attached are as-builts, certificate of completion & compliance, and other information for Wexley Chase. An inspection of the drainage facilities for this section has been made and the facilities were found to be complete and acceptable.

During construction, changes were made to the drain, which will alter the plans submitted with my report for this drain-dated October 17, 2003. The report was approved by the Board at the hearing held November 24, 2003. (See Drainage Board Minutes Book 7, Pages 258-260) The changes are as follows:

Structure:	Length:	Size	Material:	Up Invert:	Dn Invert	Grade:	Length Changes:
107-106	30	12	RCP	906.37	906.22	0.5	
106-105	88	15	RCP	906.04	905.25	0.9	1
105-101	133	18	RCP	905.13	903.76	1.03	-2
101-100	194	24	RCP	903.59	903.03	0.29	-5
104-103	44	12	RCP	907.44	907.14	0.69	-1
103-102	215	12	RCP	906.24	904.5	0.81	
110-108	61	12	RCP	904.91	904.27	1.06	
109-108	30	12	RCP	904.73	904.37	1.2	
102-108	175	18	RCP	904.14	903.77	0.21	
130-129	119	12	RCP	902.9	900.75	1.81	-9
129-128	394	12	RCP	900.61	894.55	1.54	-2
125-124	30	12	RCP	904.07	903.84	0.77	
124-123	154	15	RCP	903.73	903.28	0.29	
123-122	75	15	RCP	903.28	902.94	0.45	
134-133	20	12	RCP	903.14	902.3	4.85	
133-132	145	12	RCP	902.22	900.41	1.25	
132-131	27	15	RCP	900.2	900.05	0.57	-4
136-135	50	12	RCP	896.62	894.85	3.58	-16
115-114	224	12	RCP	909.91	908.92	0.44	-6
114-113	70	12	RCP	908.85	908.37	0.69	
113-112	128	18	RCP	908.25	907.67	0.45	3
112-111	61	18	RCP	907.76	907.59	0.28	-6
119-118	109	12	RCP	911.07	910.55	0.48	-1

118-117	105	12	RCP	910.53	909.01	1.45	
117-116	89	12	RCP	909.01	908.48	0.47	-1
117-121	30	12	RCP	909.06	909.01	0.17	
127-EX	17	12	RCP	908.78	908.59	0.95	
108-102	46	15	RCP	904.35	904.3	0.11	
120-119	32	12	RCP	911.36	911.09	0.86	-3
116-113	47	15	RCP	908.48	908.27	0.45	2

6" SSD Streets:

Tram Ln	821.5
Wexley Ct	215
Tuscany Blvd	724
KilKenny Cir	1034.5
Totalx2:	<u>5490</u>

6" SSD Lots:

Detention Basin	319
Total:	<u>319</u>

RCP Pipe Totals:

12	1814
15	437
18	497
24	194
Total:	<u>2942</u>

The length of the drain due to the changes described above is now **8,751 feet**.

The non-enforcement was approved by the Board at its meeting on November 24, 2003 and recorded under instrument #200400018963.

The following sureties were guaranteed by Madison Community Bank and released by the Board on its June 13, 2005 meeting.

Bond-LC No: 3226
Insured For: Storm Sewers
Amount: \$139,898
Issue Date: June 16, 2003

Bond-LC No: 3225
Insured For: Erosion Control
Amount: \$48,075
Issue Date: June 16, 2003

I recommend the Board approve the drain's construction as complete and acceptable.

Sincerely,

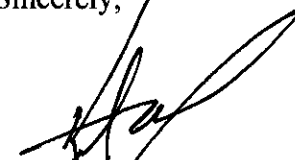

Kenton C. Ward,
Hamilton County Surveyor

KCW/slm

WEXLEY CHASE SUBDIVISION

SECTION 29, TOWNSHIP 18N, RANGE 3E, CLAY TOWNSHIP
HAMILTON COUNTY, INDIANA
ZONED: S-1

PLANS PREPARED FOR:
GWZ-2 DEVELOPMENT LLC
9011 NORTH MERIDIAN STREET
INDIANAPOLIS, INDIANA, 46260
PHONE: (317) 573-9301
FAX: (317) 573-9100
CONTACT: MARK ZUKERMAN

DOCKET NO. 183-02

RECORD DRAWINGS

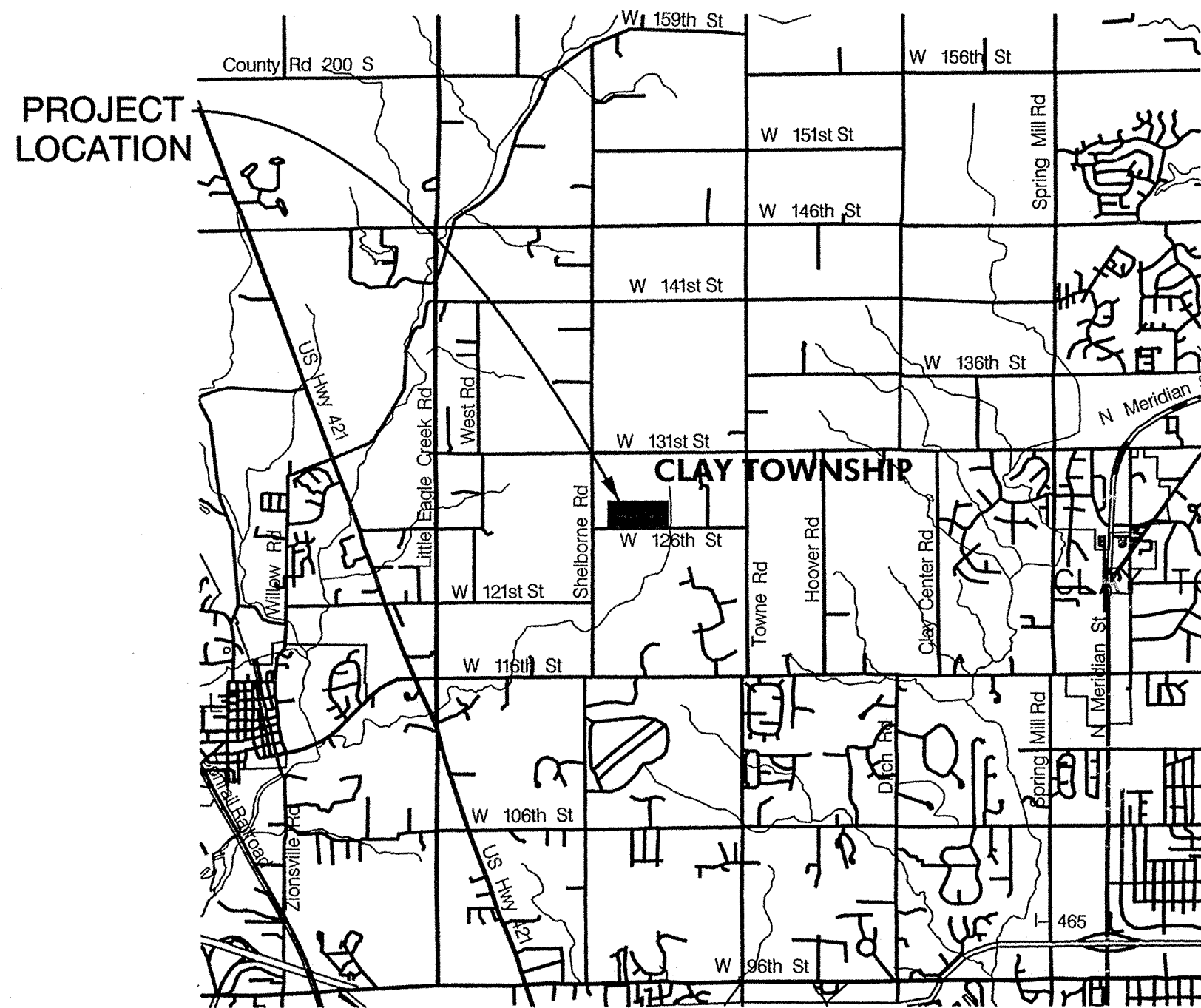

VICINITY MAP
NO SCALE

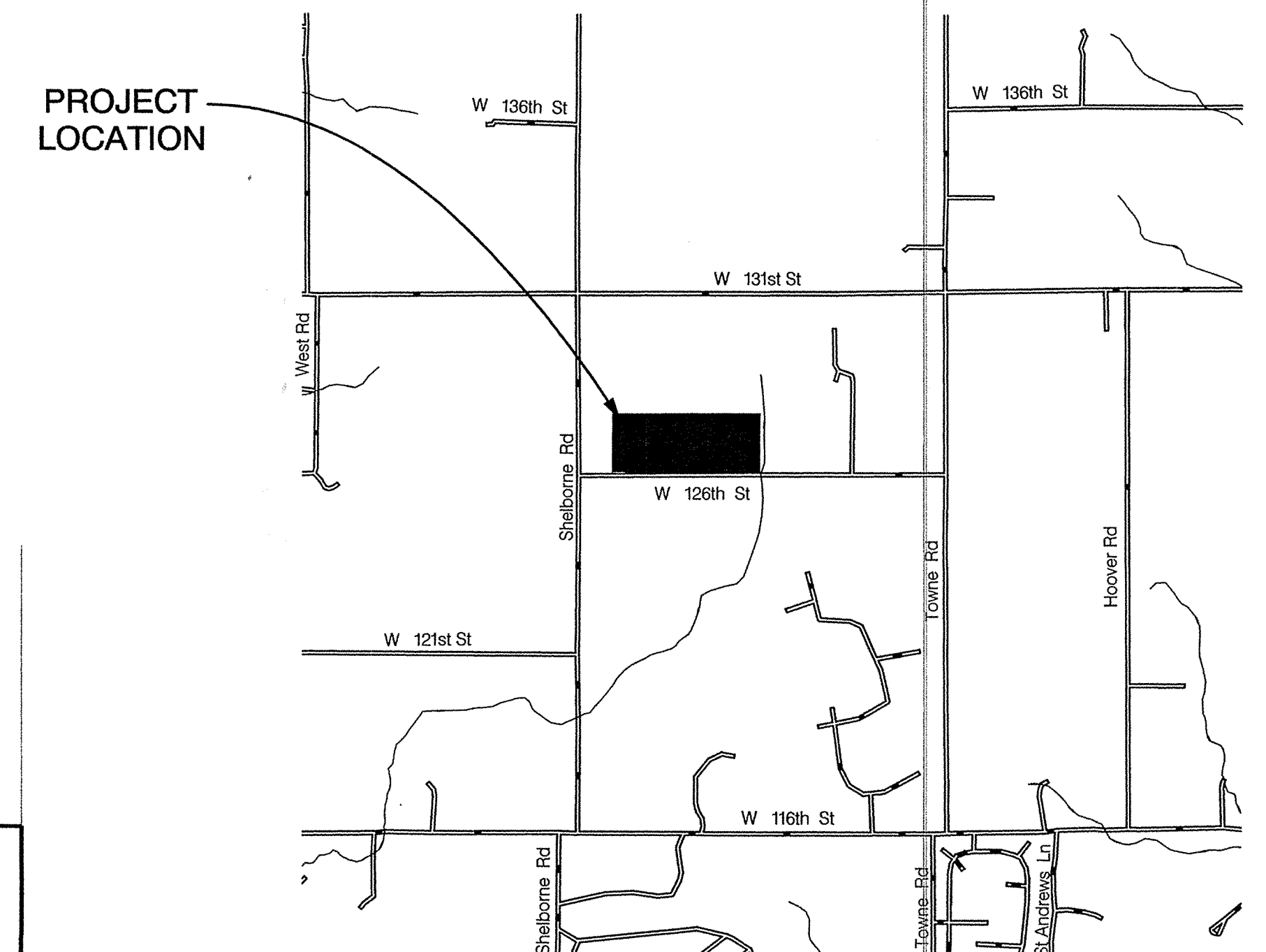

LOCATION MAP
NO SCALE

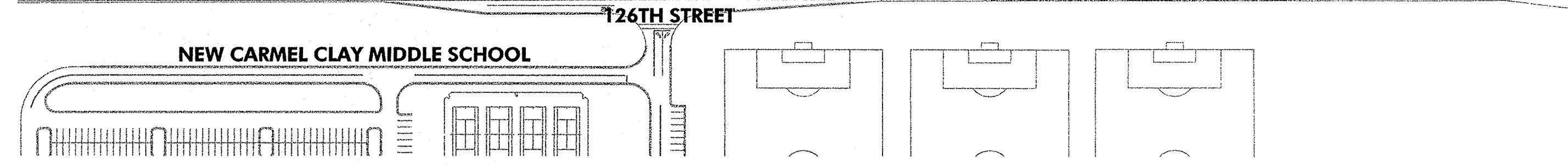
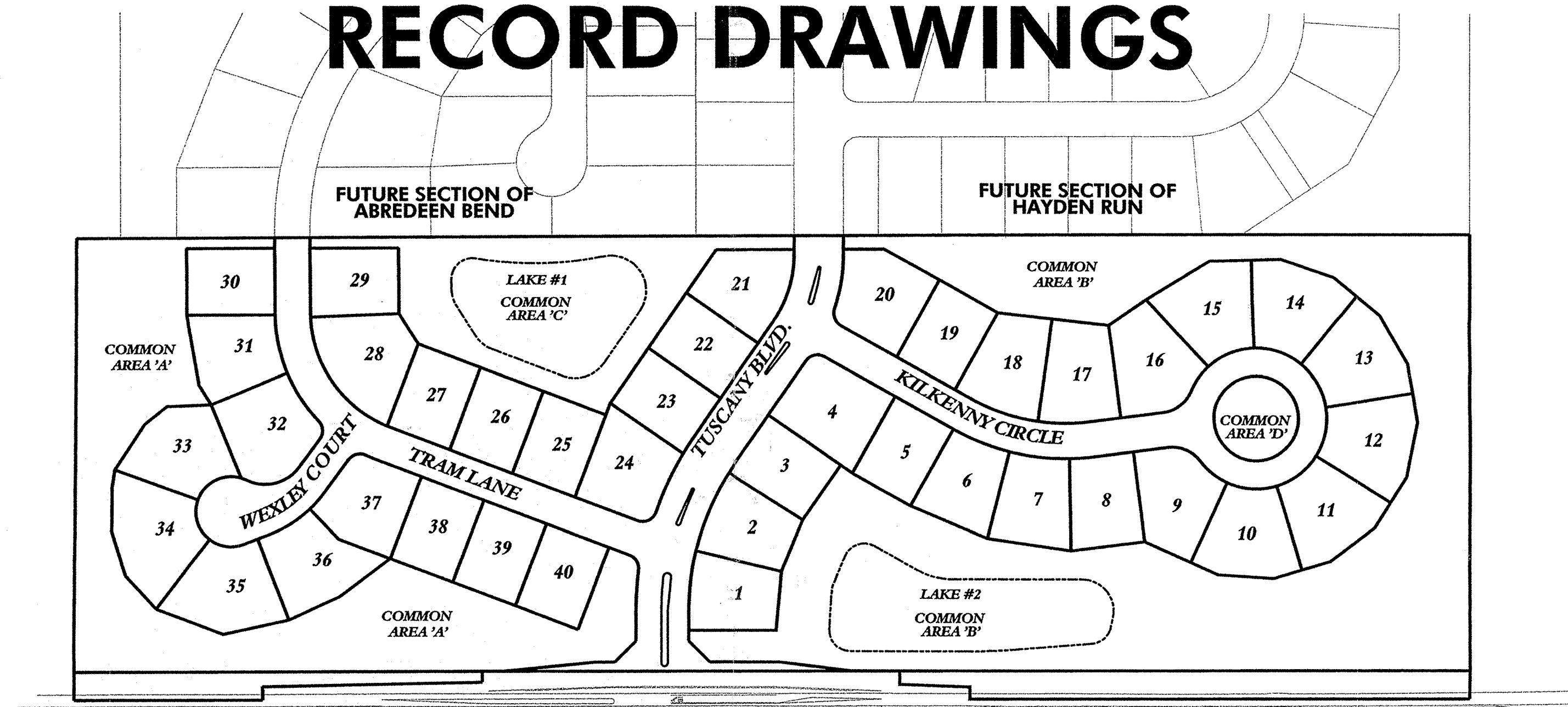

SITE MAP
SCALE: 1" = 150'

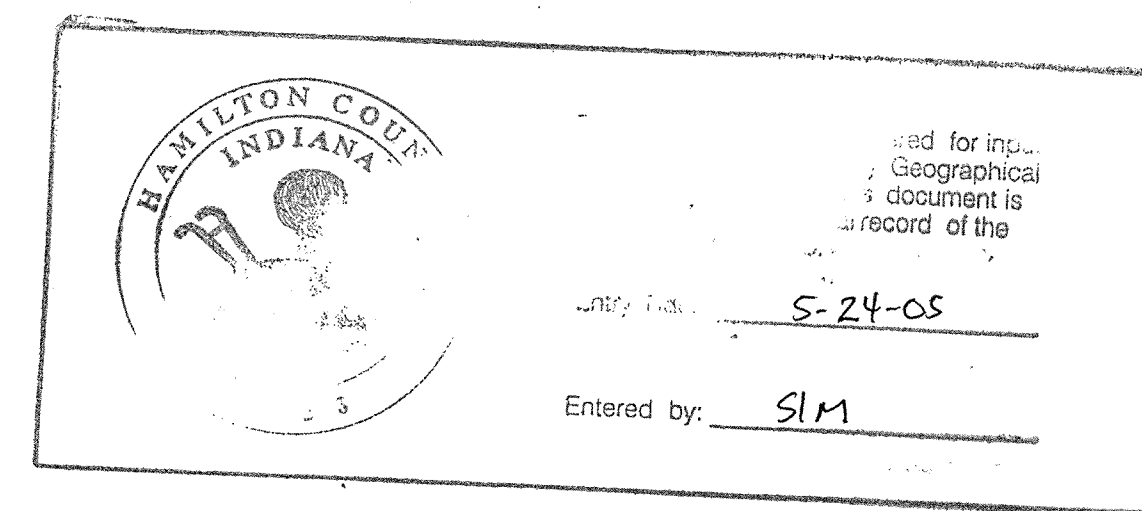

OPERATING AUTHORITIES

GAS Vectren P.O. Box 1700 Noblesville, IN, 46060 317-776-5535 CHUCK SHUPPERT	CABLE TELEVISION Time-Warner Cable 3030 Roosevelt Ave. Indianapolis, IN, 46204 317-632-9077 JASON KIRKMAN	WATER City of Carmel Water-Wastewater Utilities 130 First Avenue Carmel, IN 46032 317-571-2648 Paul Pace
ELECTRIC Cinergy /PSI 1441 South Guilford Road Carmel, IN 46032 317-776-5347 Rick McClain	STREETS Hamilton County Highway Department 1770 South 10th Street Noblesville, IN 46060 317-773-7770 STEVE BROEMANN	TELEPHONE SBC 5858 N. College Ave. Indianapolis, IN, 46220 317-972-9700 Jeremy Pendleton
SANITARY Clay Township Regional Waste District 10701 North College Avenue, Suite A Indianapolis, IN 46240 317-844-9200 Jay W. Alley	SCHOOL DISTRICT Carmel/Clay Schools 5201 East 101st Street Carmel, IN 46033 317-844-9961 Ron Farrand	

STREET NAME CHART

LINE	STREET NAME	STREET LENGTH
A	TUSCANY BOULEVARD	717.51'
B	KILKENNY CIRCLE	688.83'
C	TRAM LANE	782.92'
D	WEXLEY COURT	223.31'
E	KILKENNY CIRCLE	502.65'

25 MPH DESIGN SPEED

REVISIONS

DATE	DESCRIPTION
03-21-03	PER CARMEL WATER, NRCS, HAMILTON COUNTY HIGHWAY & SURVEYOR
04-11-03	PER NRCS COMMENT LETTER DATED 04-09-03
05-13-03	PER HAMILTON COUNTY SURVEYOR'S OFFICE COMMENT LETTER DATED 05-13-03
05-16-03	PER ON-SITE WALK THROUGH

SHEET INDEX

SHEET NO	DESCRIPTION
1	TITLE SHEET
2	EXISTING TOPOGRAPHY
3	OVERALL PLAN
4 & 5	GRADING & DRAINAGE PLAN
6 & 7	STREET PLAN & PROFILE
8	ENTRANCE PLAN
9 & 10	INTERSECTION DETAILS
11 & 12	SANITARY SEWER PLAN
13 & 14	SANITARY SEWER PLAN & PROFILE
15 - 17	STORM SEWER PLAN & PROFILE
18 & 19	WATER MAIN PLAN
20	WATER MAIN DETAILS
21 & 22	EROSION & SEDIMENT CONTROL PLAN
23	EROSION CONTROL DETAILS
24	SPECIFICATIONS
25	SANITARY SEWER DETAILS
26	STORM SEWER DETAILS
27	MISCELLANEOUS DETAILS

PLANS PREPARED BY:
BANNING ENGINEERING
698 TOWER ROAD, SUITE #100
PLAINFIELD, IN 46168
BUS. (317) 839-2581, FAX (317) 838-9171
E-MAIL banning@banning-eng.com
CONTACT: LANCE G. FERRELL

Certificate of Survey

I hereby state that the record information provided herein is true and correct to the best of my knowledge and belief and was collected under my supervision with the field data completed on JANUARY 02, 2004. The record information pertains to the location and elevation of the storm and sanitary sewer structures, the size and type of the sewer pipes, and the slope of said pipes between structures. The elevations on top of casing of the structures and their accompanying pipe inverts are accurate to within 0.05 feet and were gathered using an auto-level applying standard leveling techniques. The record locations of the sanitary sewer laterals were provided as placed by those responsible for construction of said sewer and are subject to the accuracy of the measurements provided.

Brian L. Haggard 11/13/04
Brian L. Haggard
Registered Land Surveyor - LS29800001
State of Indiana

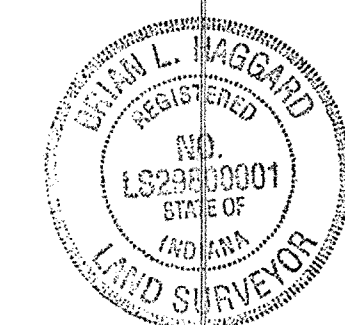

CERTIFIED BY: _____ DATE: _____

"DON'T DIG BLIND"



1-800-382-5544
CALL BEFORE YOU DIG

"DON'T DIG BLIND"



1-800-382-5544
CALL BEFORE YOU DIG

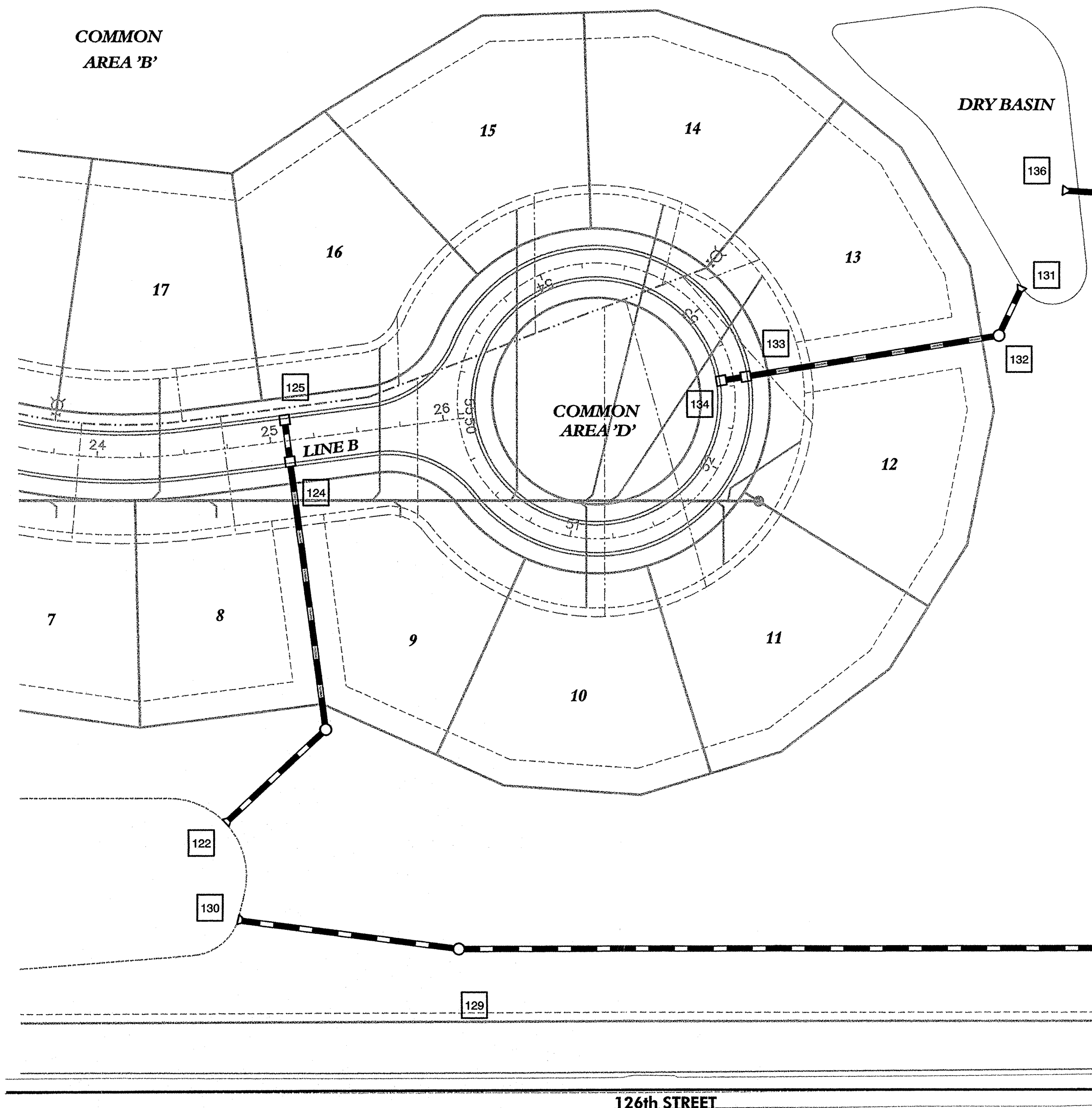

RECORD DRAWINGS

SCALE:
1"=5' VERT.
1"=50' HOR.

STORM SEWER GENERAL NOTES

- IT SHALL BE THE CONTRACTOR'S RESPONSIBILITY TO FIELD VERIFY ALL UTILITY LOCATIONS BEFORE CONSTRUCTION BEGINS.
- ALL CONSTRUCTION ACTIVITY ON THIS SITE TO BE PERFORMED IN COMPLIANCE WITH APPLICABLE O.S.H.A. STANDARDS
- FOR THIS PROJECT ALL CASTING TYPES AND STORM SEWER CONSTRUCTION IS TO BE CONSTRUCTED IN COMPLIANCE WITH THE LOCAL GOVERNING AGENCY, IF NOT NOTED OTHERWISE IN THESE PLANS.
- DEBRIS GUARD TO BE INSTALLED AT ALL OPEN ENDED INLET (UPSTREAM END)

This information was gathered by [unclear] into the Hamilton County Geographic Information System. This document is considered an official record of the County.
Entry Date: 5-20-05
Entered by: JLM

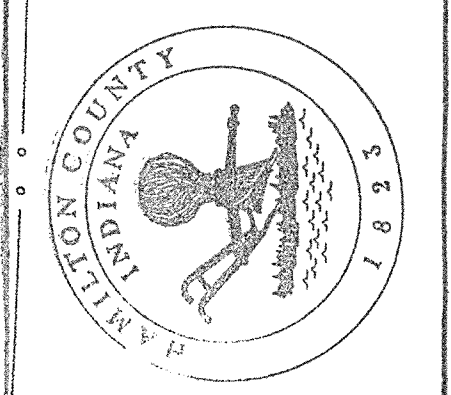

NOTE: WATER MAIN SHALL BE 24" BELOW ALL STORM SEWER CROSSINGS.

STREET NAME CHART

LINE	STREET NAME
A	TUSCANY BOULEVARD
B	KILKENNY CIRCLE
C	TRAM LANE
D	WEXLEY COURT
E	KILKENNY CIRCLE

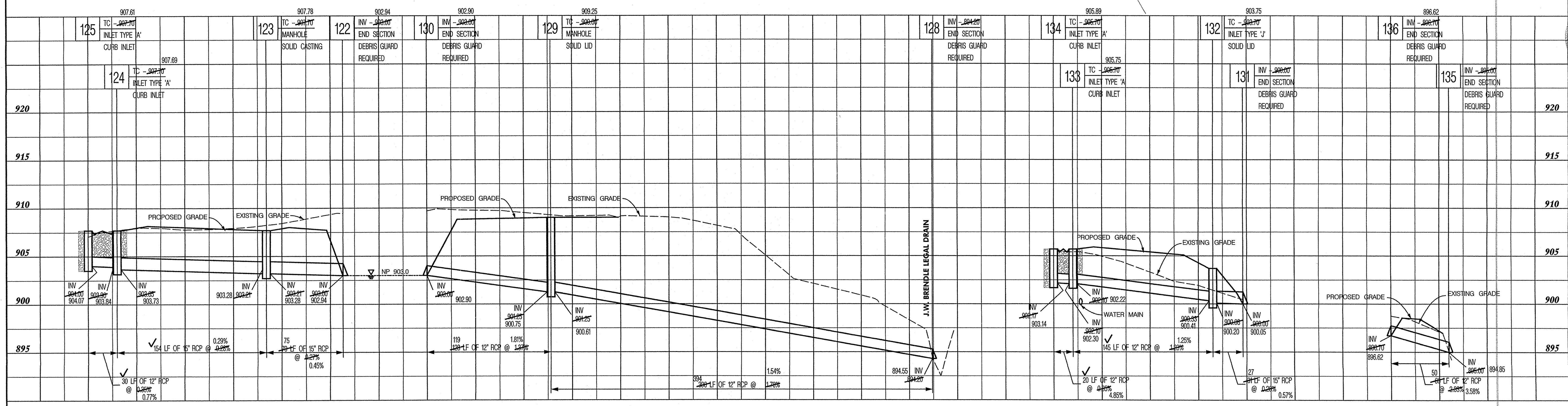

STORM SEWER PLAN & PROFILE
WEXLEY CHASE
HAMILTON COUNTY
CARMEL, INDIANA

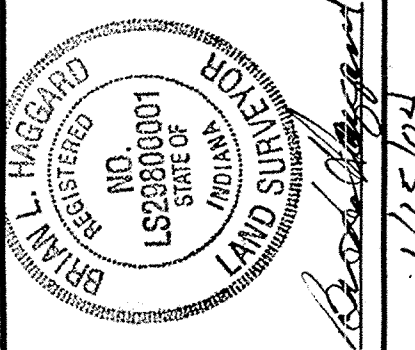

BANNING ENGINEERING
698 TOWER ROAD, SUITE #100
PLAINFIELD, IN 46168
BUS. (317) 839-2581, FAX (317) 838-9171
E-MAIL: banning@banning-eng.com

Project No: 02129
Sheet No:

WEXLEY CHASE SUBDIVISION

SECTION 29, TOWNSHIP 18N, RANGE 3E, CLAY TOWNSHIP
HAMILTON COUNTY, INDIANA
ZONED: S-1

PLANS PREPARED FOR:
GWZ-2 DEVELOPMENT LLC
9011 NORTH MERIDIAN STREET
INDIANAPOLIS, INDIANA, 46260
PHONE: (317) 573-9301
FAX: (317) 573-9100
CONTACT: MARK ZUKERMAN

DOCKET NO. 183-02

RECORD DRAWINGS

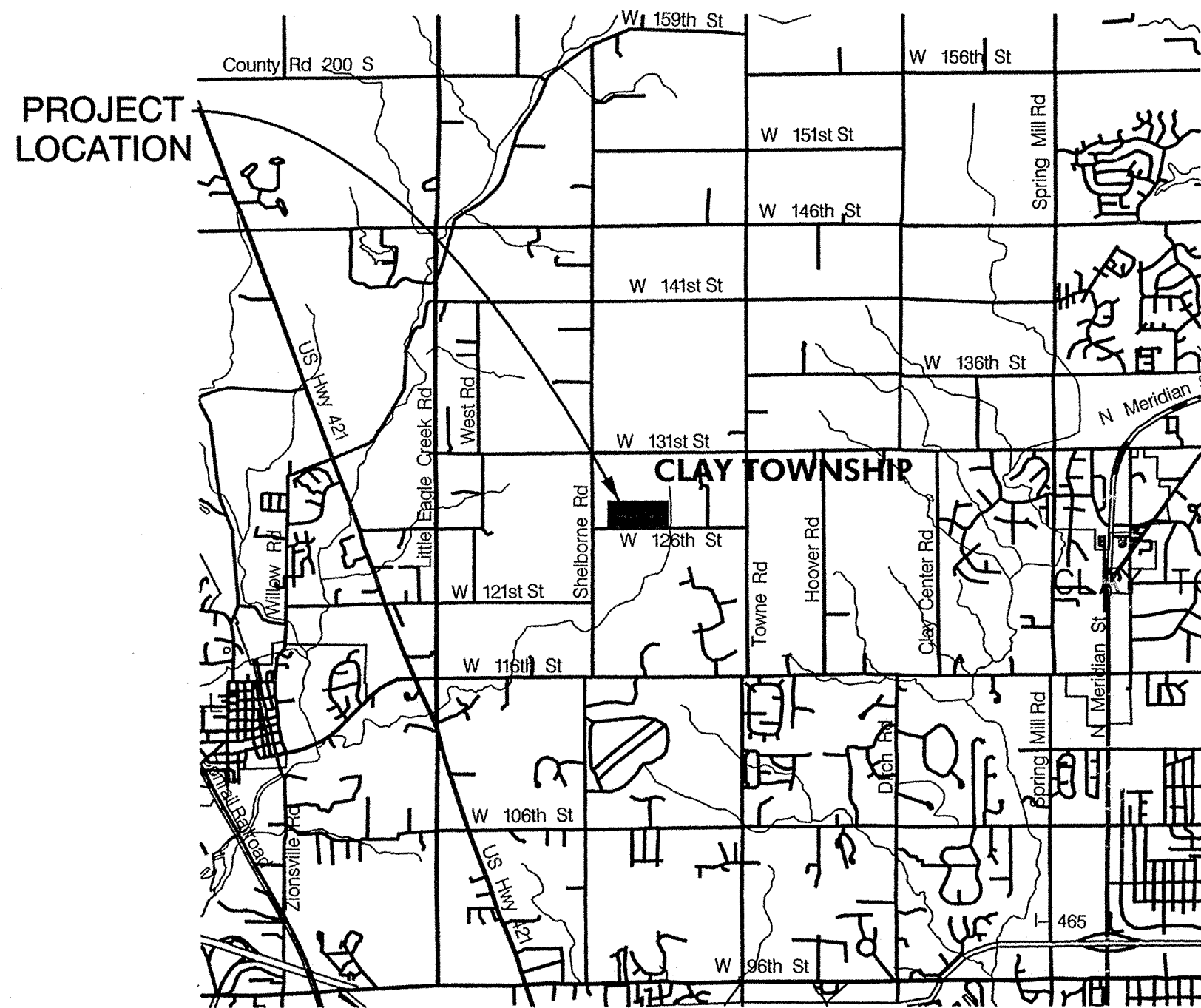

VICINITY MAP
NO SCALE

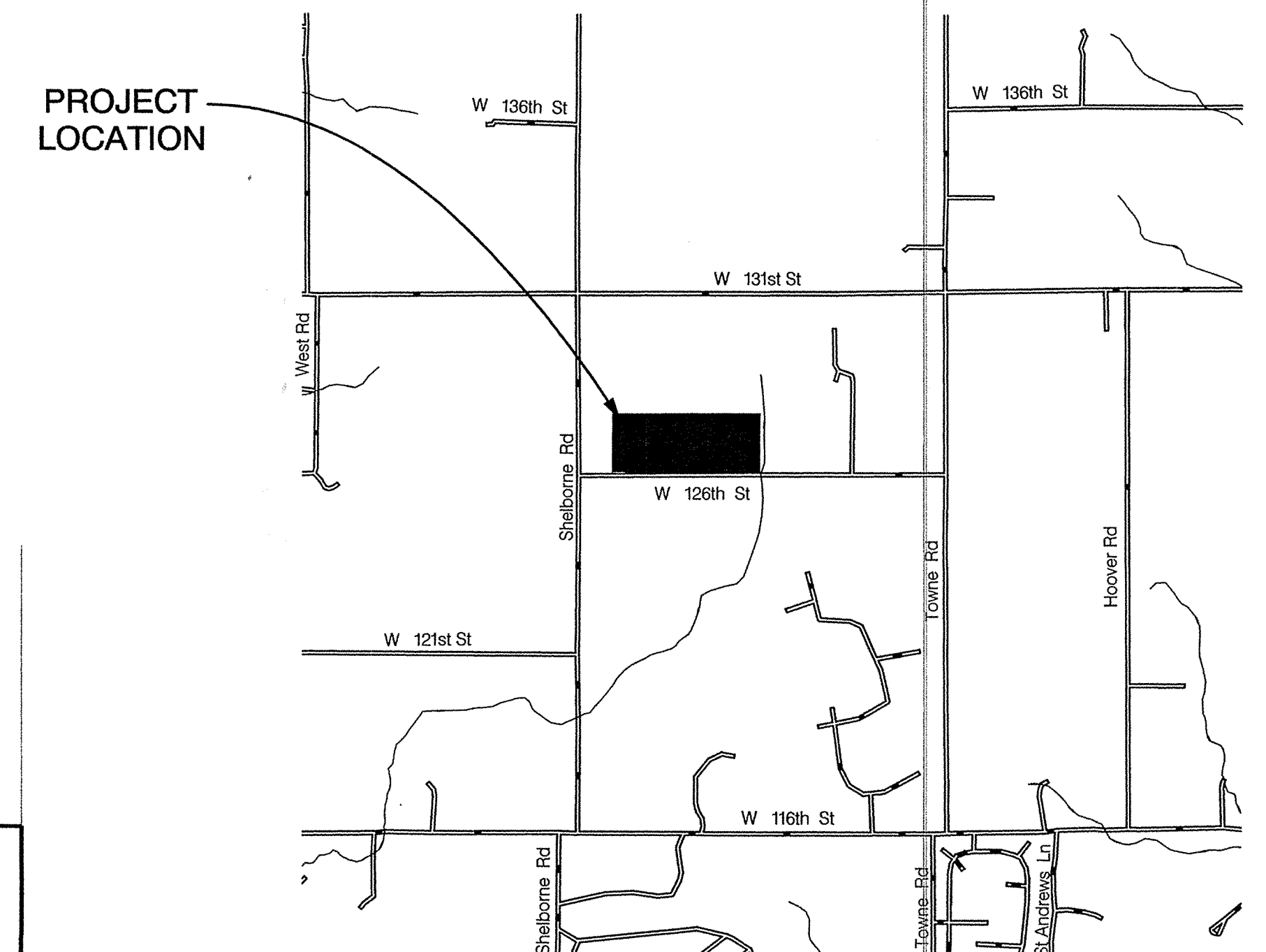

LOCATION MAP
NO SCALE

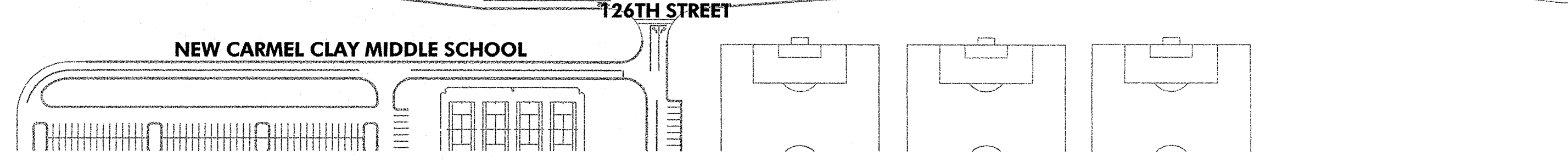
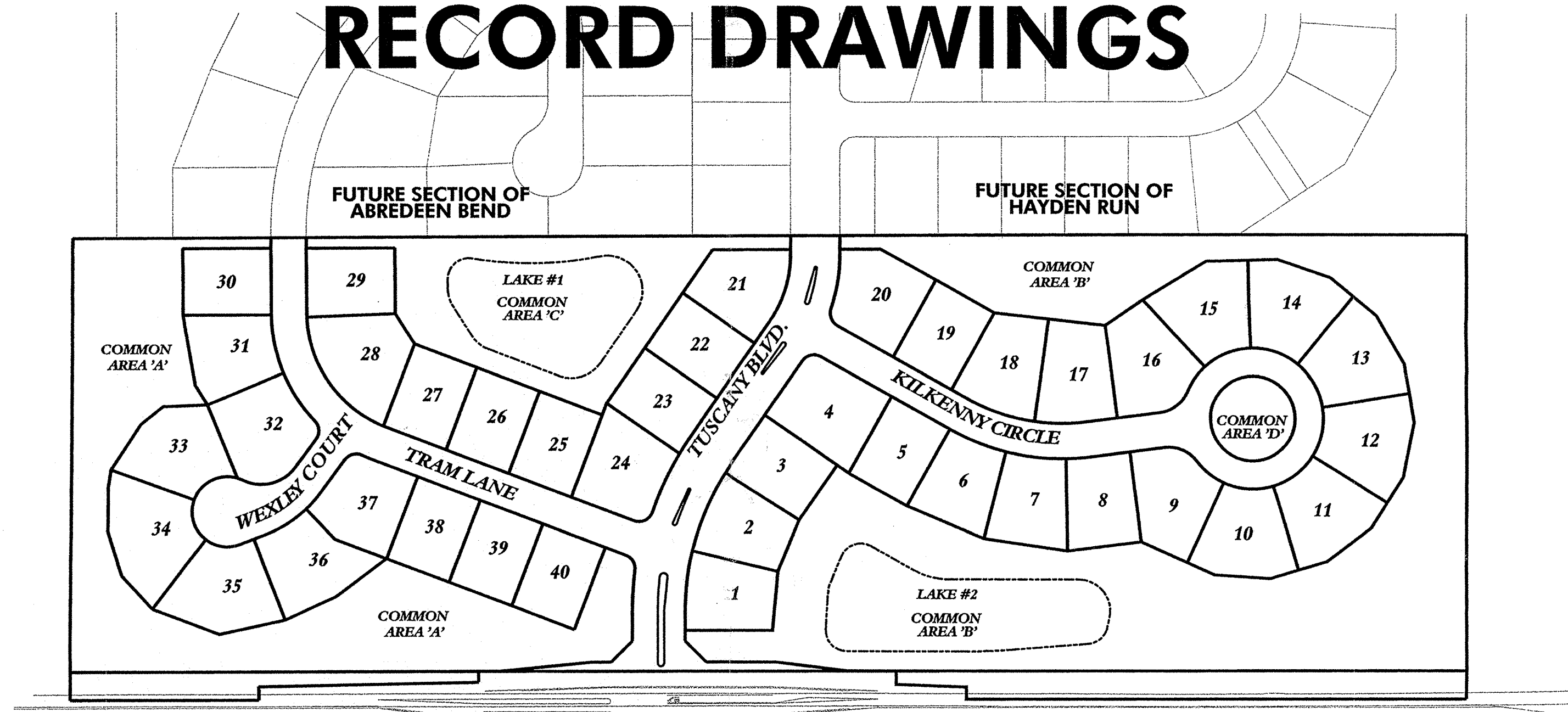

SITE MAP
SCALE: 1" = 150'

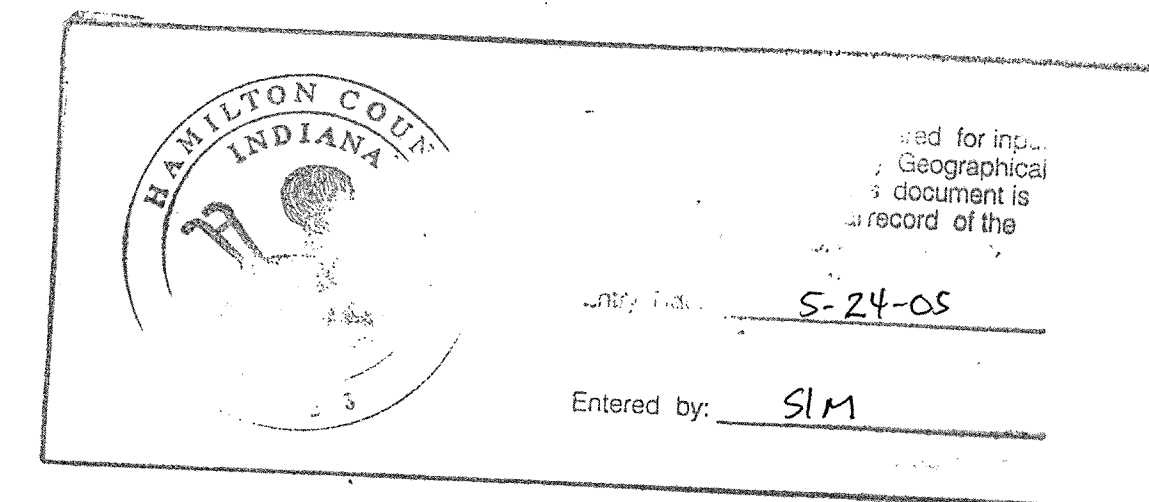

OPERATING AUTHORITIES

GAS Vectren P.O. Box 1700 Noblesville, IN, 46060 317-776-5535 CHUCK SHUPPERT	CABLE TELEVISION Time-Warner Cable 3030 Roosevelt Ave. Indianapolis, IN, 46204 317-632-9077 JASON KIRKMAN	WATER City of Carmel Water-Wastewater Utilities 130 First Avenue Carmel, IN 46032 317-571-2648 Paul Pace
ELECTRIC Cinergy /PSI 1441 South Guilford Road Carmel, IN 46032 317-776-5347 Rick McClain	STREETS Hamilton County Highway Department 1770 South 10th Street Noblesville, IN 46060 317-773-7770 STEVE BROEMANN	TELEPHONE SBC 5858 N. College Ave. Indianapolis, IN, 46220 317-972-9700 Jeremy Pendleton
SANITARY Clay Township Regional Waste District 10701 North College Avenue, Suite A Indianapolis, IN 46240 317-844-9200 Jay W. Alley	SCHOOL DISTRICT Carmel/Clay Schools 5201 East 101st Street Carmel, IN 46033 317-844-9961 Ron Farrand	

STREET NAME CHART

LINE	STREET NAME	STREET LENGTH
A	TUSCANY BOULEVARD	717.51'
B	KILKENNY CIRCLE	688.83'
C	TRAM LANE	782.92'
D	WEXLEY COURT	223.31'
E	KILKENNY CIRCLE	502.65'

25 MPH DESIGN SPEED

REVISIONS

DATE	DESCRIPTION
03-21-03	PER CARMEL WATER, NRCS, HAMILTON COUNTY HIGHWAY & SURVEYOR
04-11-03	PER NRCS COMMENT LETTER DATED 04-09-03
05-13-03	PER HAMILTON COUNTY SURVEYOR'S OFFICE COMMENT LETTER DATED 05-13-03
05-16-03	PER ON-SITE WALK THROUGH

SHEET INDEX

SHEET NO	DESCRIPTION
1	TITLE SHEET
2	EXISTING TOPOGRAPHY
3	OVERALL PLAN
4 & 5	GRADING & DRAINAGE PLAN
6 & 7	STREET PLAN & PROFILE
8	ENTRANCE PLAN
9 & 10	INTERSECTION DETAILS
11 & 12	SANITARY SEWER PLAN
13 & 14	SANITARY SEWER PLAN & PROFILE
15 - 17	STORM SEWER PLAN & PROFILE
18 & 19	WATER MAIN PLAN
20	WATER MAIN DETAILS
21 & 22	EROSION & SEDIMENT CONTROL PLAN
23	EROSION CONTROL DETAILS
24	SPECIFICATIONS
25	SANITARY SEWER DETAILS
26	STORM SEWER DETAILS
27	MISCELLANEOUS DETAILS

PLANS PREPARED BY:

BANNING ENGINEERING
698 TOWER ROAD, SUITE #100
PLAINFIELD, IN 46168
BUS. (317) 839-2581, FAX (317) 838-9171
E-MAIL banning@banning-eng.com
CONTACT: LANCE G. FERRELL

Certificate of Survey

I hereby state that the record information provided herein is true and correct to the best of my knowledge and belief and was collected under my supervision with the field data completed on JANUARY 02, 2004. The record information pertains to the location and elevation of the storm and sanitary sewer structures, the size and type of the sewer pipes, and the slope of said pipes between structures. The elevations on top of casing of the structures and their accompanying pipe inverts are accurate to within 0.05 feet and were gathered using an auto-level applying standard leveling techniques. The record locations of the sanitary sewer laterals were provided as placed by those responsible for construction of said sewer and are subject to the accuracy of the measurements provided.

Brian L. Haggard 11/2/04
Brian L. Haggard
Registered Land Surveyor - LS29800001
State of Indiana

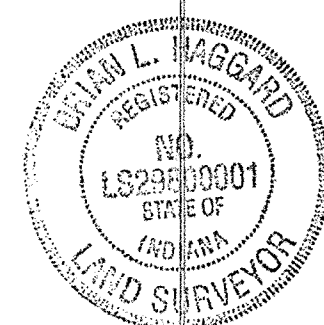

CERTIFIED BY: _____ DATE: _____

"DON'T DIG BLIND"



1-800-382-5544
CALL BEFORE YOU DIG

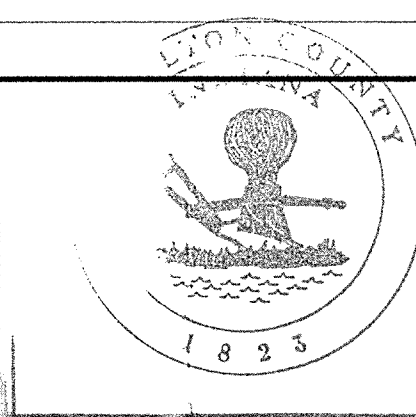

This information was gathered for input into the Hamilton County Geographical Information System. This document is considered an official record of the GIS.
 Entry Date: 5-24-05
 Entered by: SLM

RECORD DRAWINGS

SCALE:
 1"=5' VERT.
 1"=50' HOR.

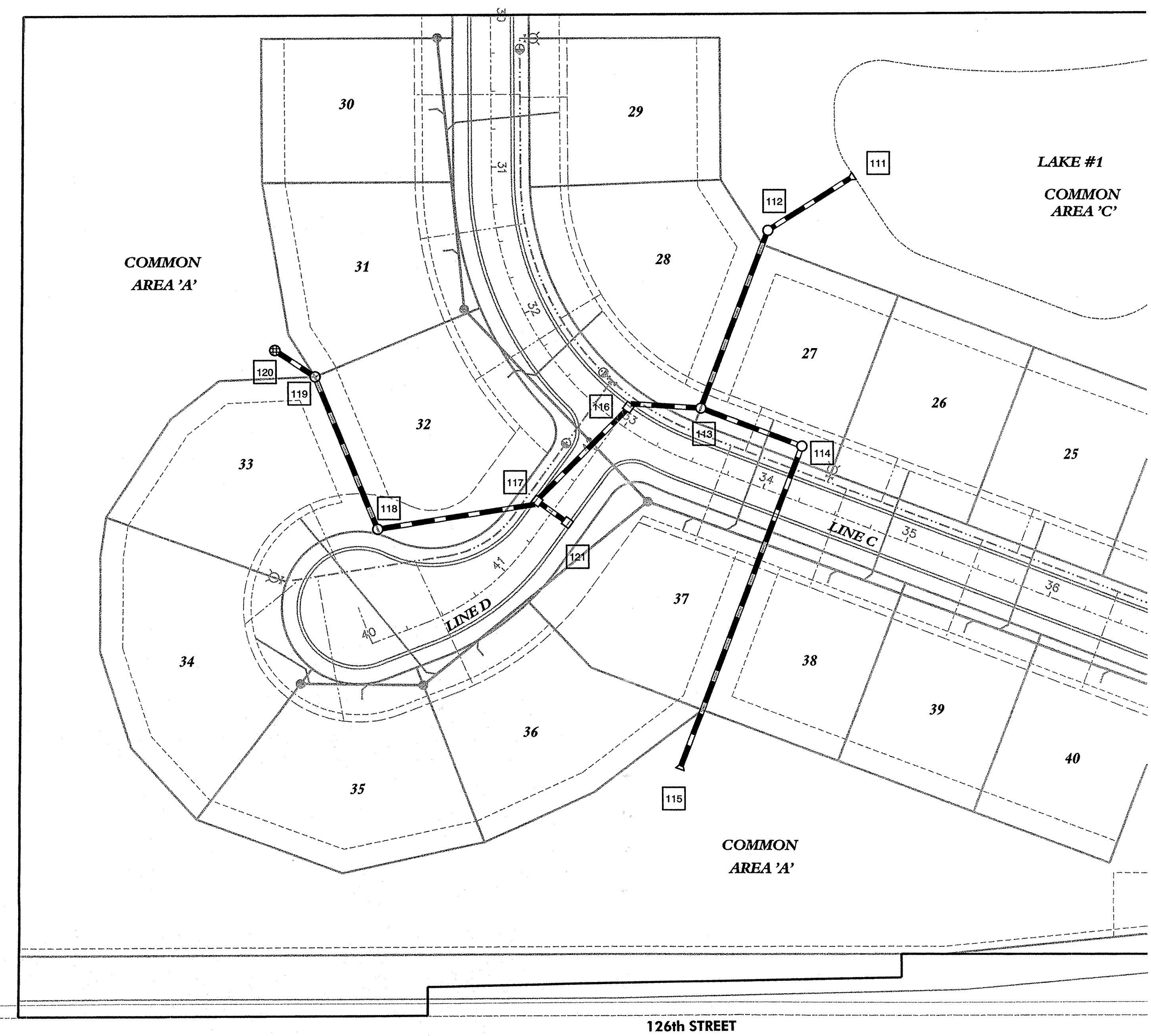

STORM SEWER GENERAL NOTES

- IT SHALL BE THE CONTRACTOR'S RESPONSIBILITY TO FIELD VERIFY ALL UTILITY LOCATIONS BEFORE CONSTRUCTION BEGINS.
- ALL CONSTRUCTION ACTIVITY ON THIS SITE TO BE PERFORMED IN COMPLIANCE WITH APPLICABLE O.S.H.A. STANDARDS
- FOR THIS PROJECT ALL CASTING TYPES AND STORM SEWER CONSTRUCTION IS TO BE CONSTRUCTED IN COMPLIANCE WITH THE LOCAL GOVERNING AGENCY, IF NOT NOTED OTHERWISE IN THESE PLANS.
- DEBRIS GUARD TO BE INSTALLED AT ALL OPEN ENDED INLET (UPSTREAM END)



NOTE: WATER MAIN SHALL BE 24" BELOW ALL STORM SEWER CROSSINGS.

STREET NAME CHART

LINE	STREET NAME
A	TUSCANY BOULEVARD
B	KILKENNY CIRCLE
C	TRAM LANE
D	WEXLEY COURT
E	KILKENNY CIRCLE

STORM SEWER PLAN & PROFILE
WEXLEY CHASE
HAMILTON COUNTY
CARMEL, INDIANA

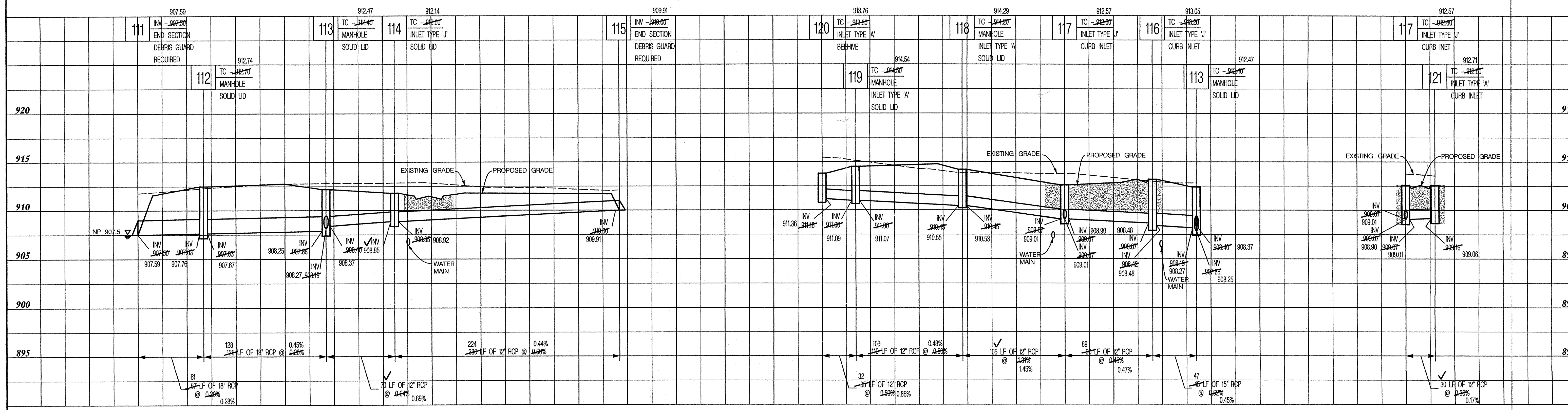
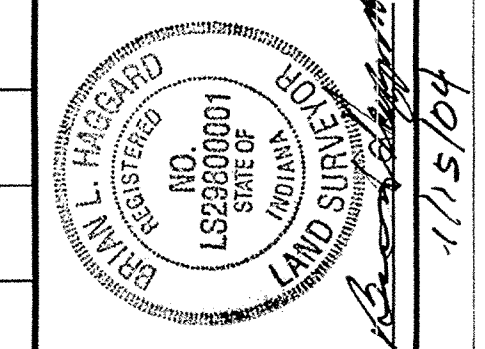

BANNING ENGINEERING
 698 TOWER ROAD, SUITE #100
 PLAINFIELD, IN 46168
 BUS. (317) 839-2581, FAX (317) 838-9171
 E-MAIL banning@banning-eng.com

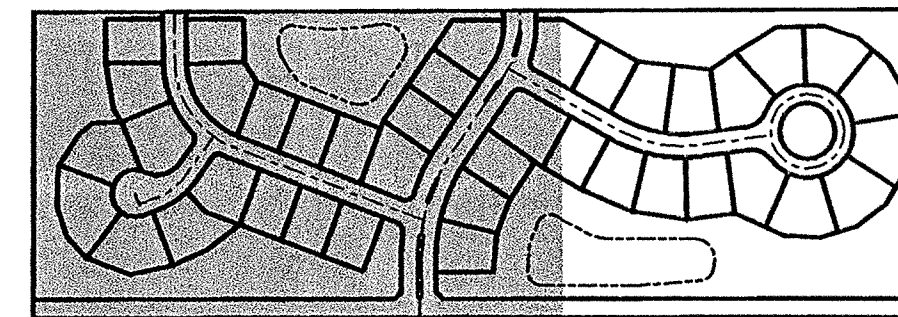

KEYMAP
NO SCALE

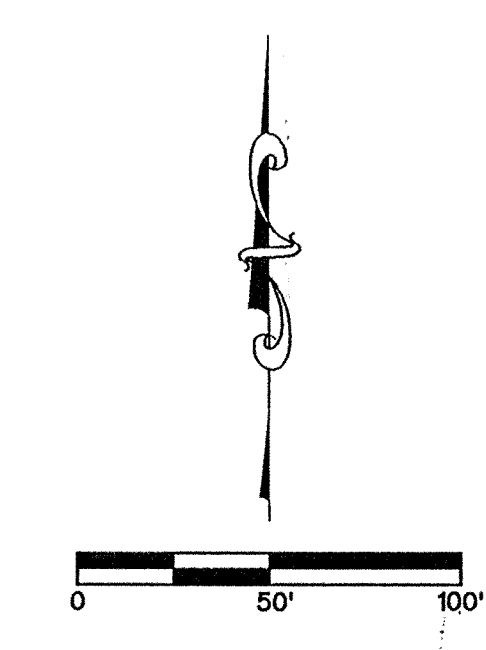

FUTURE SECTION
ABERDEEN BEND

FUTURE SECTION
HAYDEN RUN

LEGEND

EXISTING

- ===== STORM SEWER
- SANITARY SEWER
- WATER LINE
- X-X- FENCE LINE
- G GAS LINE
- OHE OVERHEAD UTILITIES
- MANHOLE
- ⊕ STORM INLET
- ⊕ FIRE HYDRANT
- ▲ WATER VALVE
- ⊕ ELECTRIC TRANSFORMER
- CATV OR TELEPHONE PEDESTAL

PROPOSED

- ===== STORM SEWER
- SANITARY SEWER
- WATER LINE
- SD SUB-SURFACE DRAIN
- SANITARY MH
- STORM MH
- ⊕ STORM INLET
- ⊕ SANITARY STRUCTURE NO.
- ⊕ STORM STRUCTURE NO.
- BUILDING PAD
- 29 (872.5) LOT NUMBER
- 873.6 FLOOD PROTECTION GRADE
- PAD ELEVATION
- (NP) NO PAD
- MFF MINIMUM FINISH FLOOR
- 910.2 SUB-DRAIN INVERT

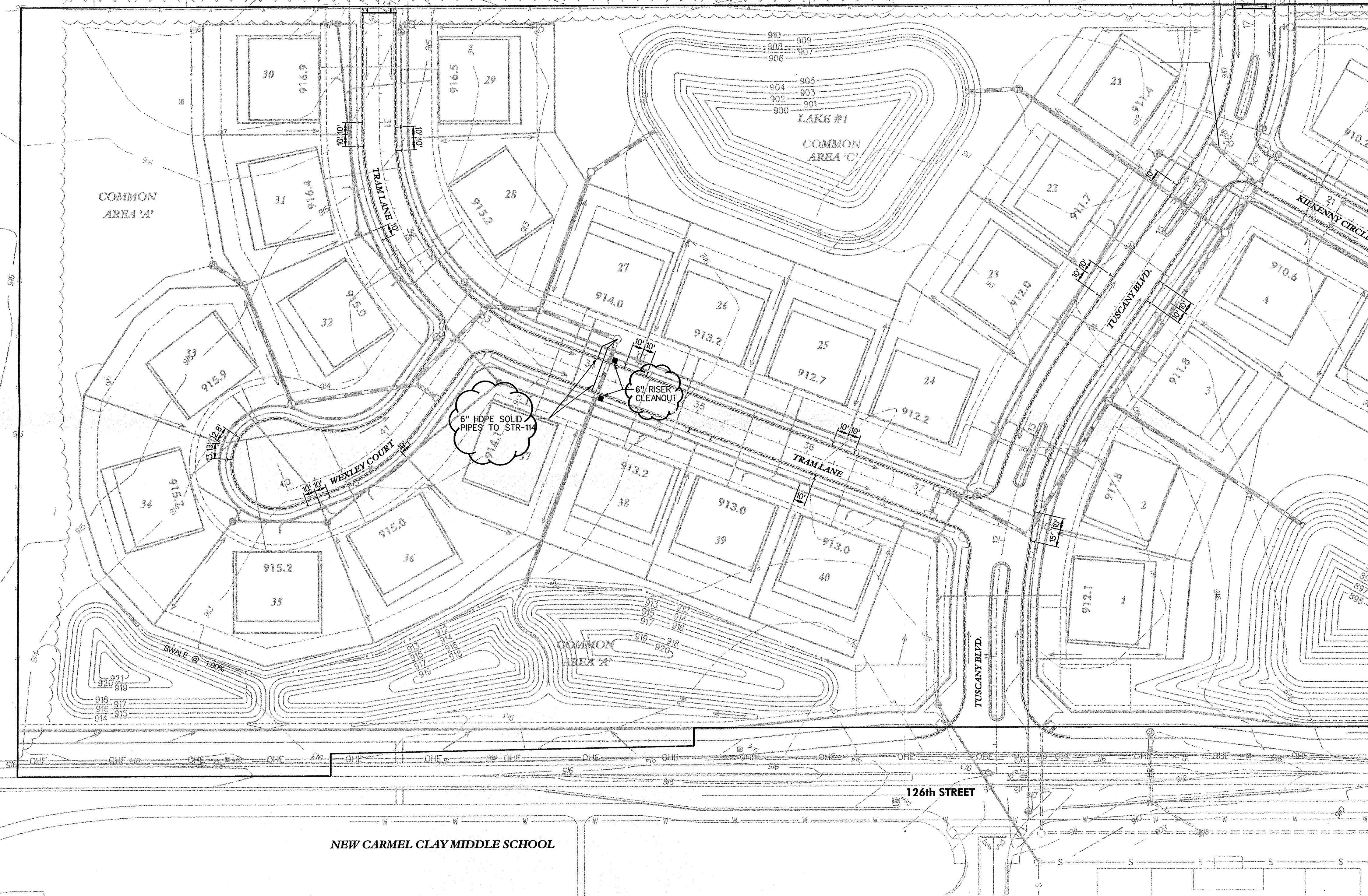

NEW CARMEL CLAY MIDDLE SCHOOL

126th STREET

6" SUB SURFACE DRAIN ON THE WEST SIDE OF THE 12" RCP TURNS NORTH @ 34+10 AND TIES INTO STRUCTURE #114; 6" HDPE SOLID PIPE WAS USED AND BOTH SIDES OF STREET SSD WAS KEPT INDEPENDENT OF EACH OTHER.

6" SUBSURFACE DRAIN ON THE EAST SIDE OF THE 12" RCP TURNS TOWARD THE CURBS ON EACH SIDE OF THE STREET @ 34+40 AND A 6" RISER CLEANOUT WAS INSTALLED BEHIND THE CURB ON EACH SIDE OF THE STREET. CLEANOUTS WERE INSTALLED PER HAMILTON COUNTY SPECIFICATIONS.

STRUCTURE #114 WAS CHANGED TO A 48" ROUND STRUCTURE TO ACCOMMODATE THE SSD CHANGE.



RECORD DRAWINGS

Revisions	Date
PER HAMILTON COUNTY SURVEYOR	03-21-03
PER HAMILTON COUNTY SURVEYOR	03-21-03
PER HAMILTON COUNTY SURVEYOR	06-19-03
Designed: LCF	
Drawn: SJH	
Checked:	
Scale: 1"=50'	
Date: 02-25-03	

SUB-SURFACE DRAIN PLAN
WEXLEY CHASE
HAMILTON COUNTY
CARMEL, INDIANA

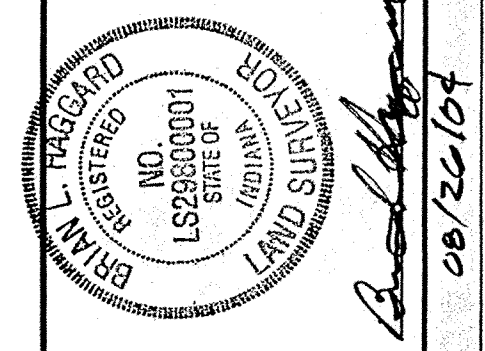

BANNING ENGINEERING
 698 TOWER ROAD, SUITE #700
 PLAINFIELD, IN 46168
 BUS. (317) 839-2581, FAX (317) 838-9171
 E-MAIL banning@banning-eng.com

Project No:	02129
Sheet No:	1 of 2

RECORD DRAWINGS

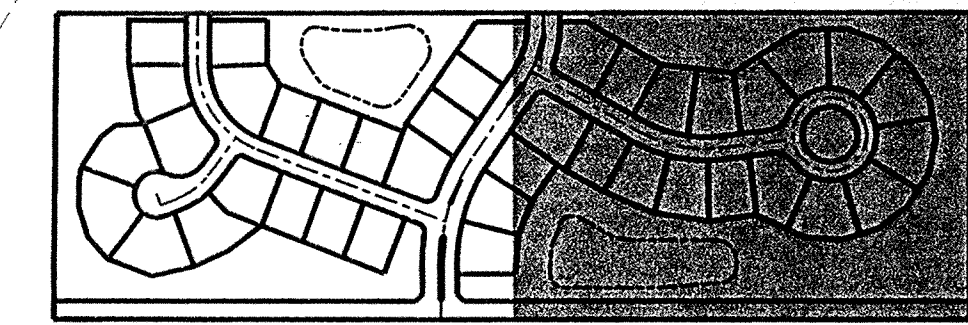
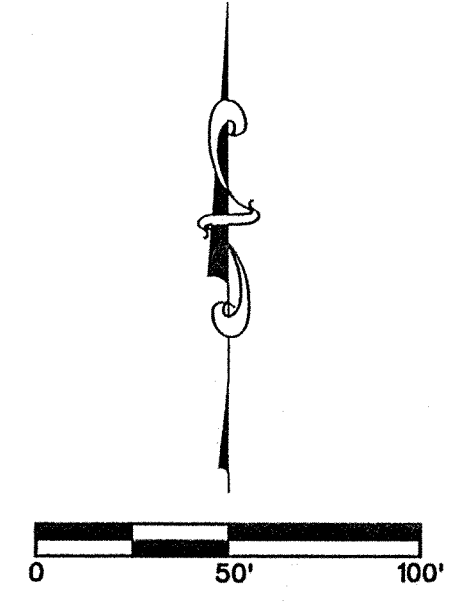

KEYMAP
NO SCALE

- LEGEND**
- EXISTING**
- ===== STORM SEWER
 - S — SANITARY SEWER
 - W — WATER LINE
 - X-X- FENCE LINE
 - G — GAS LINE
 - OHE — OVERHEAD UTILITIES
 - MANHOLE
 - ⊕ STORM INLET
 - ⊕ FIRE HYDRANT
 - ⊕ WATER VALVE
 - ⊕ ELECTRIC TRANSFORMER
 - ⊕ CATV OR TELEPHONE PEDESTAL
- PROPOSED**
- ===== STORM SEWER
 - S — SANITARY SEWER
 - W — WATER LINE
 - SD — SUB-SURFACE DRAIN
 - SANITARY MH
 - STORM MH
 - ⊕ STORM INLET
 - ⊕ SANITARY STRUCTURE NO.
 - ⊕ STORM STRUCTURE NO.
 - BUILDING PAD
 - 29 LOT NUMBER
 - (872.5) FLOOD PROTECTION GRADE
 - 873.6 PAD ELEVATION
 - (NP) NO PAD
 - MFF MINIMUM FINISH FLOOR
 - (910.2) SUB-DRAIN INVERT

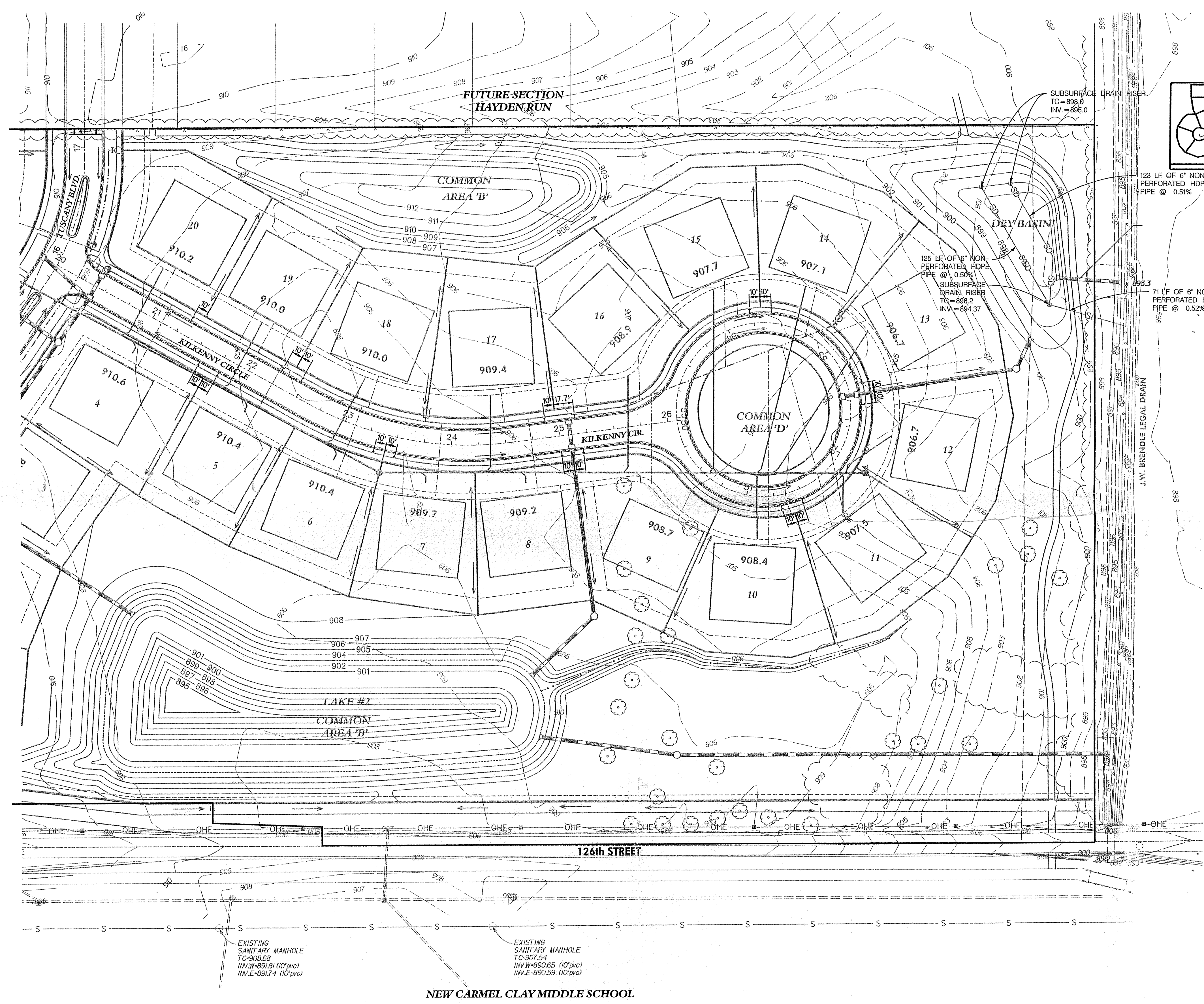

SUB-SURFACE DRAIN PLAN
WEXLEY CHASE
HAMILTON COUNTY
CARMEL, INDIANA

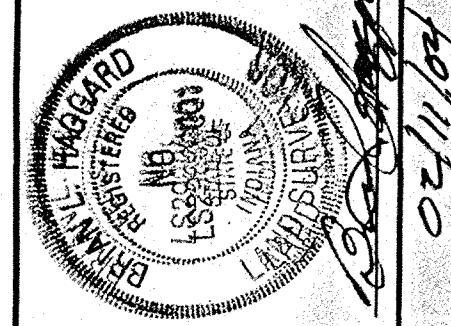

BANNING ENGINEERING
 698 TOWER ROAD, SUITE #100
 PLAINFIELD, IN 46168
 BUS. (317) 839-2581, FAX (317) 838-9171
 E-MAIL banning@banning-eng.com

Project No: 02129
 Sheet No:

